

Top view

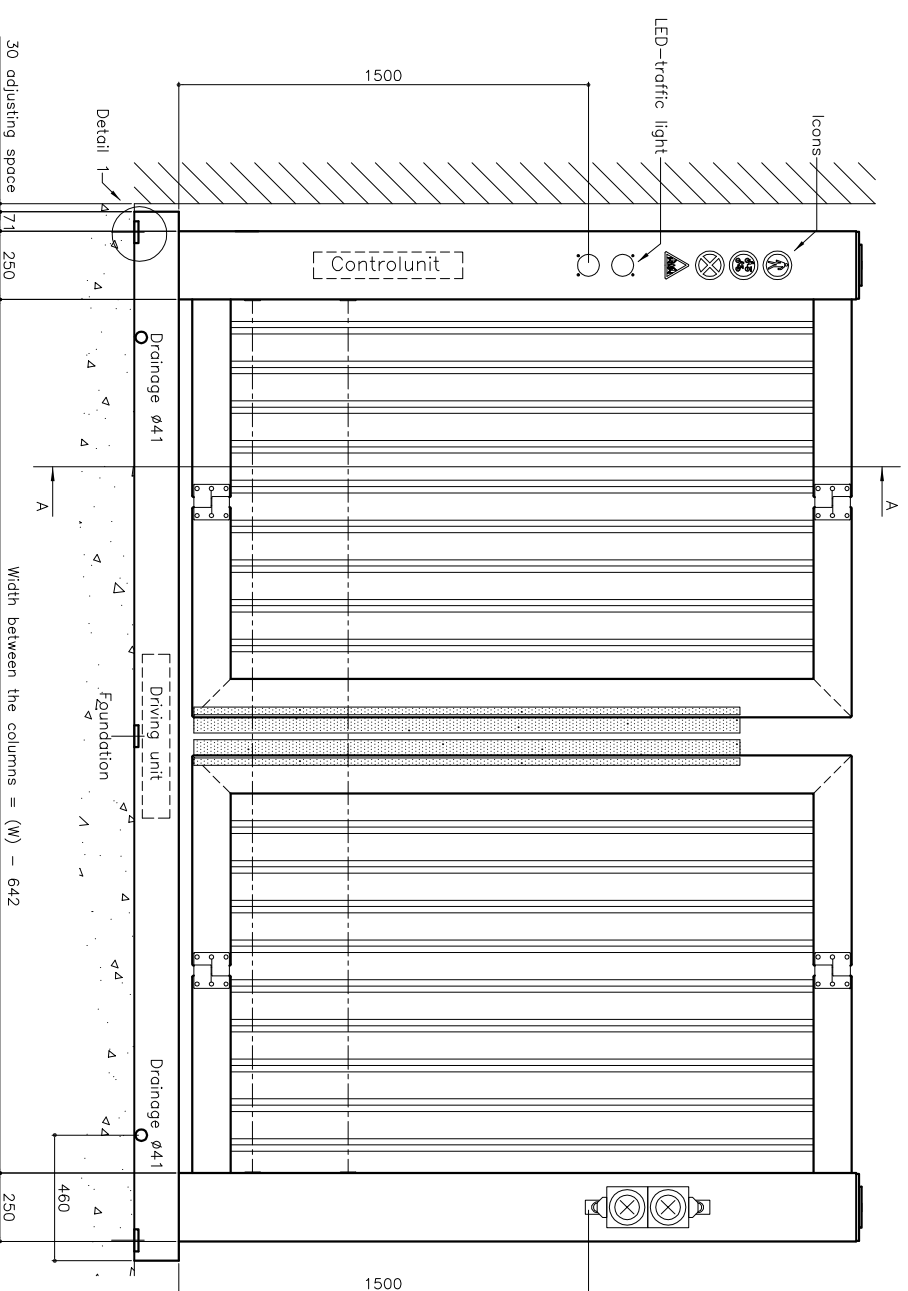

Front view

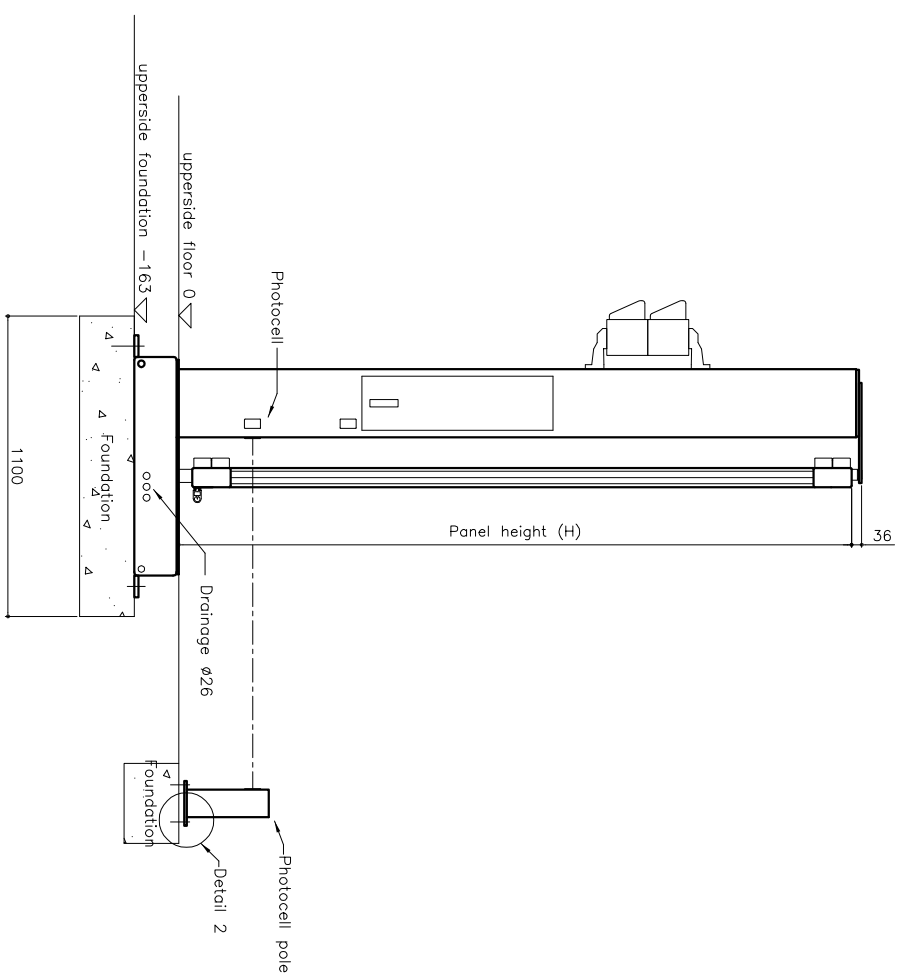

Section A-A

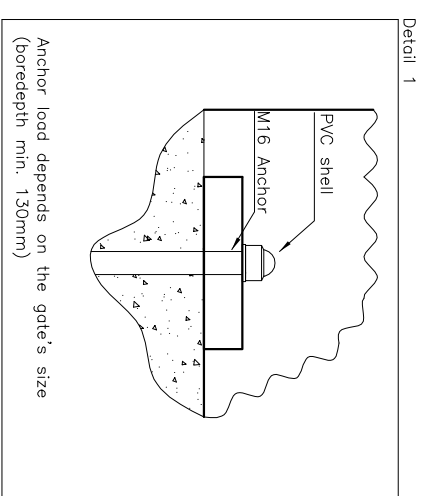

Detail 1

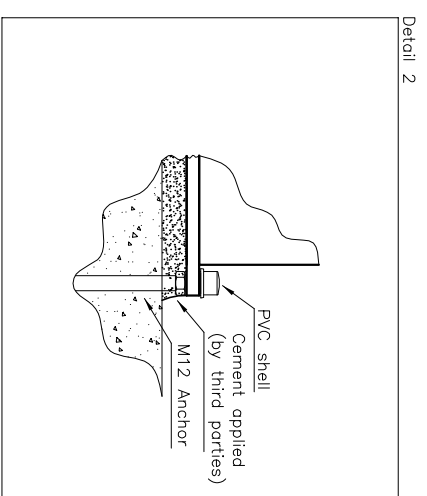

Detail 2

**Comments:**

- Only the main components are drawed
- Fundation equal and horizontal max ± 2mm
- Rainwater discharge apply by client
- Cable ducting needs to be applied by client according to cable plan

**HOLLAND TRAFFIC CONTROL**

INDUSTRIESTRAAT 13, MOERKAPELLE TEL.: 079-5933200 WWW.HTCBV.COM  
 POSTBUS 35, 2750 AA MOERKAPELLE FAX.: 079-5933311 info@htcbv.com

THIS DRAWING IS OWNED BY BRS SPEEDGATES B.V. AND MAY NOT BE REPRODUCED, COPIED IN WHOLE OR IN PART, OR GIVEN TO THIRD PARTIES FOR INSPECTION WITHOUT EXPRESS WRITTEN PERMISSION OF BRS SPEEDGATES B.V.

Client: \_\_\_\_\_ Location: \_\_\_\_\_

Project: \_\_\_\_\_ Correspondent on location: \_\_\_\_\_

Part: Xentry lowerdriven Phone number on location: \_\_\_\_\_

Rev	Date	By	Chgd
0	04-03-08	MS	HV
A			
B			
C			
D			
E			
F			
G			

Dwg. nr.: G01

Scale: \_\_\_\_\_

By: \_\_\_\_\_

Orderrr.: \_\_\_\_\_

**FOR APPROVAL**

APPROVED \_\_\_\_\_

YES NO \_\_\_\_\_

SIGNATURE: \_\_\_\_\_

Attributes Xentry lower-driven:

- Powdercoating Rot:???
- Roll / base galvanized
- Panel surrounding: 0 K60x60 X K140x70
- Panel filling: K35x35 0 Design 0.....
- Controls: 0 n/a X Standard settings (on request)